

REL NO	REV	DETAILS	DWN	CKD	APVD	DATE
ECO-141192	G	PRODUCTION RELEASE. ZONE D3; NETT WEIGHT VALUES ADDED TO TABLE.	DGL	DGL	SMH	03FEB14

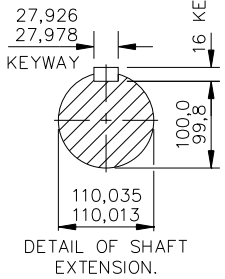

CORE	4-POLE		6-POLE	
	c OF G	WT (kg)	c OF G	WT (kg)
G	595	1969	575	1641
H	605	2120	585	1848
J	620	2269	600	2024
K	-	-	620	2276

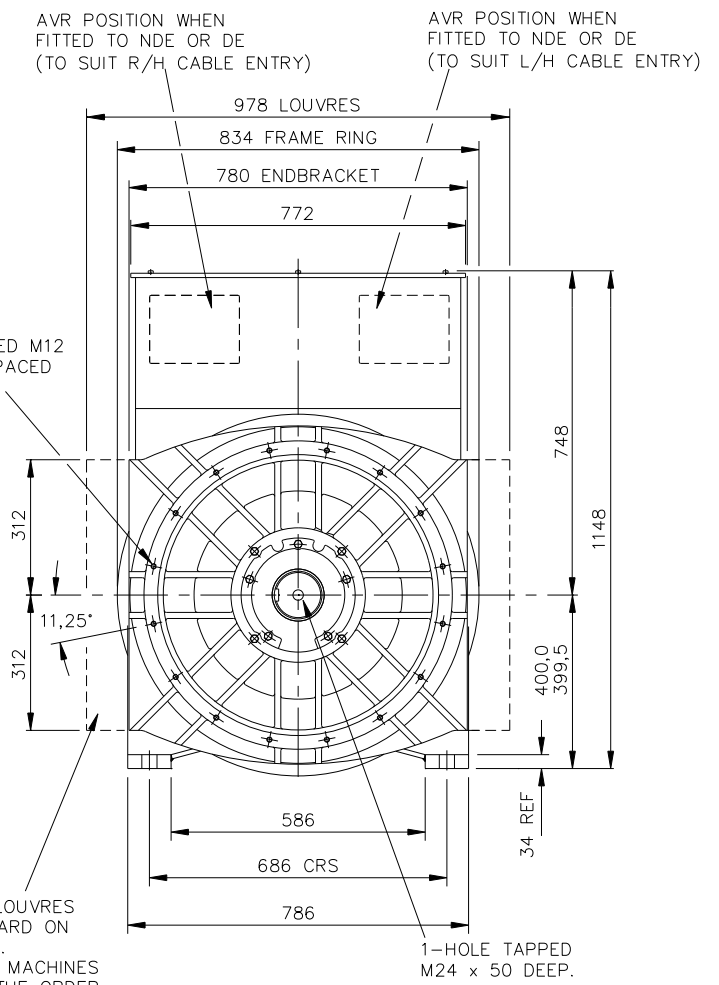
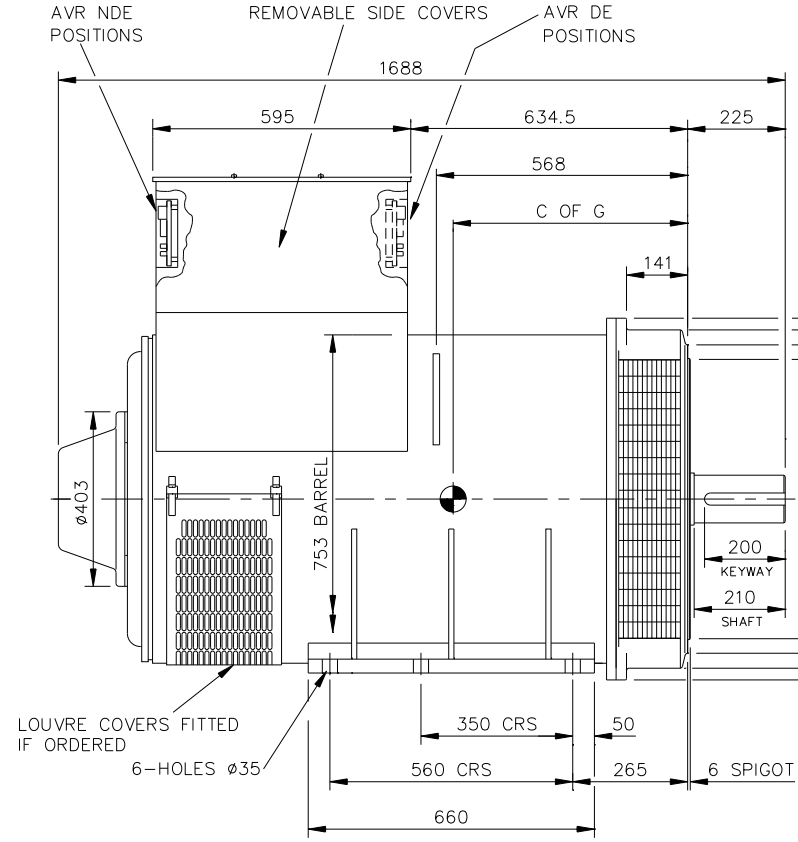

NOTE! CUSTOMER MAY CUT CABLE ENTRY HOLES AS REQUIRED IN ANY OF THE FOUR TERMINAL BOX SIDES, SUBJECT TO POSITION OF AVR, TERMINALS ETC

UNLESS SPECIFIED ALL DIMENSIONS ARE IN MILLIMETERS			<b>CUMMINS GENERATOR TECHNOLOGIES</b>	
<b>DO NOT SCALE PRINT</b>	DRAWN AJB		DRAWING, GENERAL ASSEMBLY	
	CHECKED AJB		HC/CG6 2-BRG GHJ (4P) GHJK (6P) ALTERNATOR	
<b>CONFIDENTIAL</b>	APPROVED CR	SITE CODE	DWG SIZE	SHEET
PROPERTY OF CUMMINS GENERATOR TECHNOLOGIES	DATE 11MAY00	STA	A4	1
	SCALE 1:10	FIRST USED ON ---	66-2000	REV G

D

D

C

C

B

B

A

A