

AutoCad

4

3

2

1

CORE	C OF G (mm)	WEIGHT(KG)
C	463	850
D	483	940
E	504	1024

REL NO	REV	NO	REVISION	DWN	CKD	APVD	DATE
ECO-171701	B	1	ZONE D4,ADDED WEIGHT (850 KG) FOR C CORE	SA	PN	S_NARAYANAN	04SEP17
		2	ZONE D4,ADDED WEIGHT (940 KG) FOR D CORE	SA	PN	S_NARAYANAN	04SEP17
		3	ZONE D4,ADDED WEIGHT (1024 KG) FOR E CORE	SA	PN	S_NARAYANAN	04SEP17
		4	IN TITLE BLOCK DESCRIPTION S4L1S WAS S4	SA	PN	S_NARAYANAN	04SEP17

NOTE: -  
1. CUSTOMER MAY CUT CABLE ENTRY HOLES AS REQUIRED IN ANY OF THE FOUR TERMINAL BOX SIDES SUBJECT TO POSITION OF A.V.R, TERMINALS ETC.

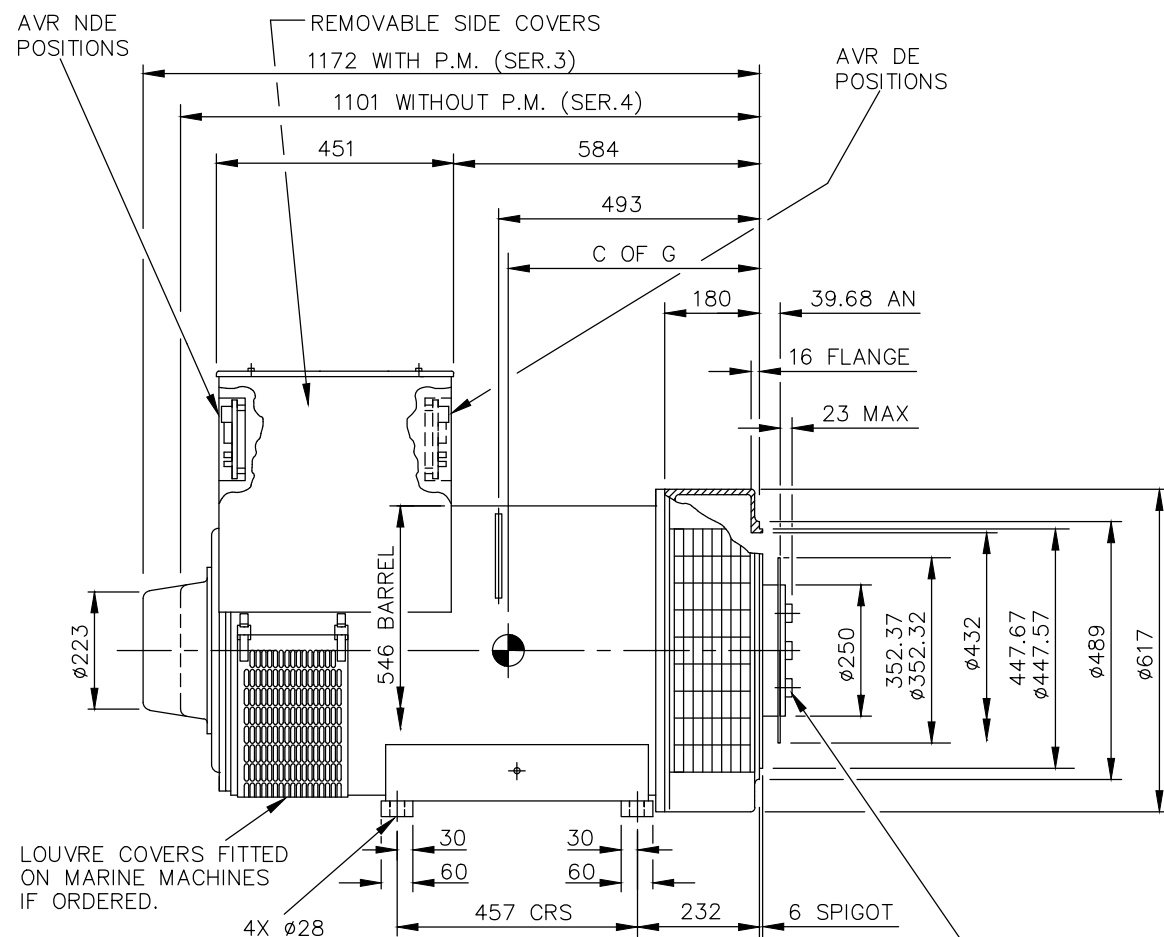

4-PLATE COUPLING TOTAL THICKNESS 4.8 mm  
HUB SECURING BOLTS TO BE TIGHTENED TO A TORQUE OF 48 kgf-m (479 N-m)

8-HOLES IN COUPLING Ø10.3  
EQUI-SPACED ON 333.37 PCD.

60° DRIP PROOF LOUVRES FITTED AS STANDARD ON MARINE MACHINES. OTHERS IF ORDERED.

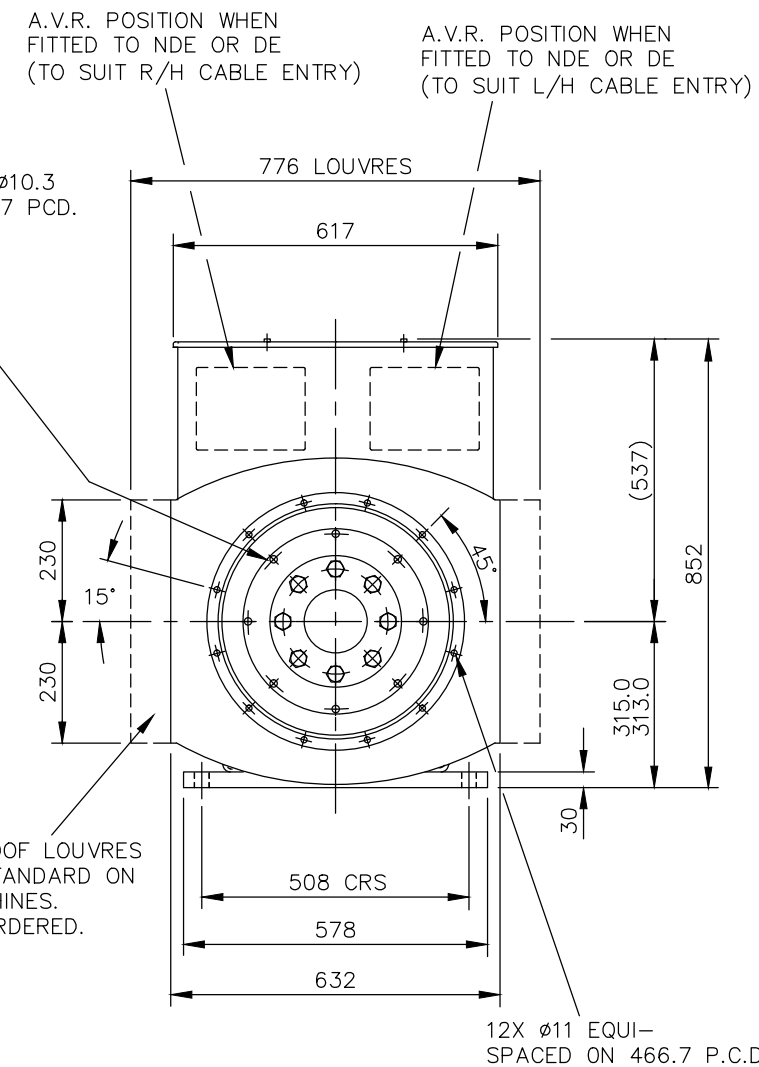

UNLESS OTHERWISE SPECIFIED, ALL DIMENSIONS ARE IN MILLIMETERS

SIM TO 41-4526

DO NOT SCALE PRINT

SCALE

1:10

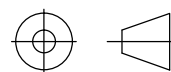

THIS DOCUMENT (AND THE INFORMATION SHOWN THEREON) IS CONFIDENTIAL AND PROPRIETARY AND SHALL NOT BE DISCLOSED TO OTHERS IN HARD COPY OR ELECTRONIC FORM, REPRODUCED BY ANY MEANS, OR USED FOR ANY PURPOSE WITHOUT WRITTEN CONSENT OF CUMMINS INC.

DRAWN S\_BALAMURUGAN

CHECKED A\_BIRARI

APPROVED B\_SURVE

DATE 27JAN17

FOR INTERPRETATION OF DIMENSIONING AND TOLERANCING, SEE ASME Y14.5-2009

FIRST USED ON

S4



SITE CODE

STA

CUMMINS GENERATOR TECHNOLOGIES

DRAWING, GENERAL ASSEMBLY

S4L1S CDE 1-BRG SAE 2/11.5 STD T/BOX

DWG SIZE

A4

A057B567

CAD SHEET  
1 of 1

4

3

2

1

A

A